

# descon DESIGNpack primary

Build excitement in your café

Create an atmosphere where students **want to eat!**

Complete package **\$3,900!**

- > Plan your look in three easy steps
- > Customize to fit your needs
- > Pays for itself with increased participation
- > Improvements your school community will appreciate

Add a 2nd line for ONLY \$2,800\* (additional)  
2 lines \$6,700!



(4) Styles Available



Healthy-U (DPP-Healthy)



Kids Café (DPP-Kids)



Mascot (DPP-Mascot)



All-Star (DPP-Star)

See pages 46-49

PRIMARY cafés

## 1 Start outside the Line(s) – grab attention & inspire



## 2 Carry inside the line(s) – distinguish & brighten



## 3 Use Anywhere – provide better information

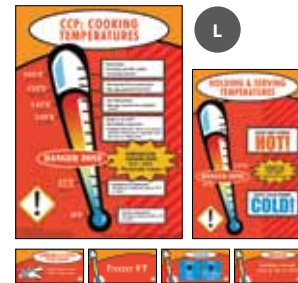
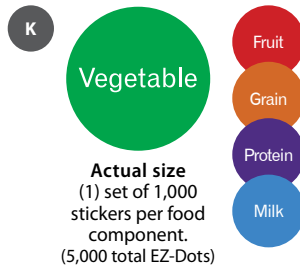

### \$3,900 Pack includes:

Additional Line | \$2,800 ea

**A** Main Sign  
44" x 23", wall mount or ceiling hung

**B** Banner Set (1) set consists of  
(2) 24" x 18" & (1) 48" x 18"

**C** Wall Art  
Choose 3 individual pieces or 1 set

**D** Change Art and Flip Frames  
22" x 28", choose (9) images

**E** Menu Board 14" x 30"  
Coordinate with A

**F** Counter Top Display  
10" x 15", coordinate with A

**G** EAM Lunch & Breakfast  
24" x 20", quantity 1, (2) inserts

**H** Healthy Link\*  
70" x 48", quantity 1, choose (6) images

**I** EZ-Tags Large  
3" x 6", quantity 1 (Bag of 10)

**J** EZ-Tags Small  
2-1/4" x 5", quantity 1 (Bag of 10)

**K** EZ-Dots 1 sheet of each:  
Veggie, Fruit, Protein, Grain & Milk

**L** Food Safety Base Kit\*  
Various sizes, set of (8) signs

\*Second line does not include items: H or L

Creating a custom look is easier than you think! **Now just choose your style**

A



Customize



B Banner set



C Various styles/sizes, p. 58-63



D 3 Frames | Choose (9) images, p. 54, 56



E

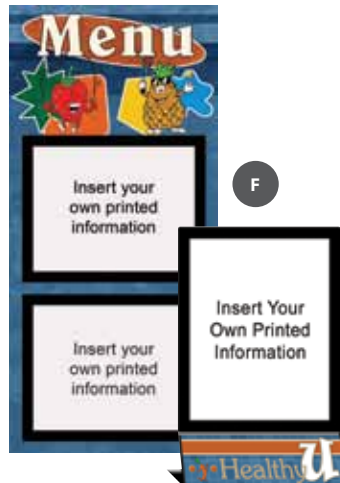

F

G



L

I/J/K

H

**\$3,900 Pack includes:** (DPP-Healthy)

Additional Line | **\$2,800** ea (DPPADD-Healthy)

- A** Main Sign  
44" x 23", wall mount or ceiling hung
- B** Banner Set (1) set consists of (2) 24" x 18" & (1) 48" x 18"
- C** Wall Art  
Choose 3 individual pieces or 1 set
- D** Change Art and Flip Frames  
22" x 28", choose (9) images
- E** Menu Board 14" x 30"  
Coordinate with A
- F** Counter Top Display  
10" x 15", coordinate with A
- G** EAM Lunch & Breakfast  
24" x 20", quantity 1, (2) inserts
- H** Healthy Link\*  
70" x 48", quantity 1, choose (6) images
- I** EZ-Tags Large  
3" x 6", quantity 1 (Bag of 10)
- J** EZ-Tags Small  
2-1/4" x 5", quantity 1 (Bag of 10)
- K** EZ-Dots 1 sheet of each:  
Veggie, Fruit, Protein, Grain & Milk
- L** Food Safety Base Kit\*  
Various sizes, set of (8) signs

\*Second line does not include items: H or L

Improvements *your school community* will appreciate

A



Customize

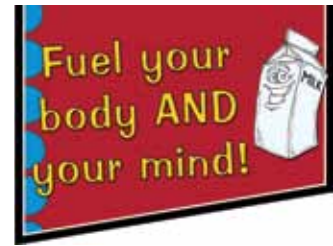
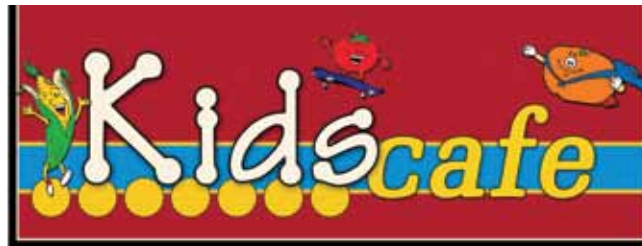

B Banner set

C Various styles/sizes, p. 58-63



D 3 Frames | Choose (9) images, p. 54, 56



E

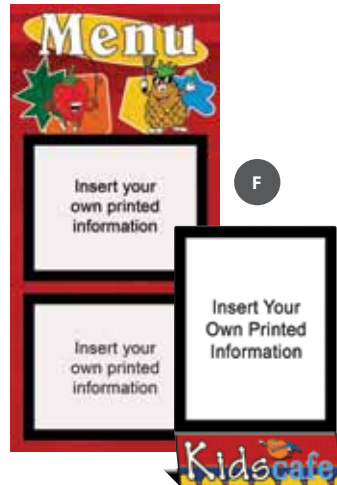

F

G



L

**\$3,900 Pack includes:** (DPP-Kids)

Additional Line | **\$2,800** ea (DPPADD-Kids)

- A Main Sign  
44" x 23", wall mount or ceiling hung
- B Banner Set (1) set consists of  
(2) 24" x 18" & (1) 48" x 18"
- C Wall Art  
Choose 3 individual pieces or 1 set
- D Change Art and Flip Frames  
22" x 28", choose (9) images

- E Menu Board 14" x 30"  
Coordinate with A
- F Counter Top Display  
10" x 15", coordinate with A
- G EAM Lunch & Breakfast  
24" x 20", quantity 1, (2) inserts
- H Healthy Link\*  
70" x 48", quantity 1, choose (6) images

- I EZ-Tags Large  
3" x 6", quantity 1 (Bag of 10)
- J EZ-Tags Small  
2-1/4" x 5", quantity 1 (Bag of 10)
- K EZ-Dots 1 sheet of each:  
Veggie, Fruit, Protein, Grain & Milk
- L Food Safety Base Kit\*  
Various sizes, set of (8) signs

\*Second line does not include items: H or L

**See pages 48/49 for more style selections!**

A



Customize

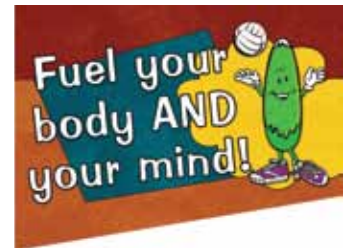

B Banner set

C Various styles/sizes, p. 58-63



D 3 Frames | Choose (9) images, p. 54, 56



E

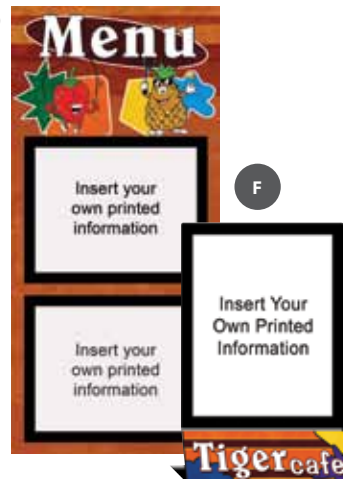

F



G

L

V/J/K

H

**\$3,900 Pack includes:** (DPP-Mascot)

Additional Line | **\$2,800** ea (DPPADD-Mascot)

- A Main Sign  
44" x 23", wall mount or ceiling hung
- B Banner Set (1) set consists of  
(2) 24" x 18" & (1) 48" x 18"
- C Wall Art  
Choose 3 individual pieces or 1 set
- D Change Art and Flip Frames  
22" x 28", choose (9) images

- E Menu Board 14" x 30"  
Coordinate with A
- F Counter Top Display  
10" x 15", coordinate with A
- G EAM Lunch & Breakfast  
24" x 20", quantity 1, (2) inserts
- H Healthy Link\*  
70" x 48", quantity 1, choose (6) images

- I EZ-Tags Large  
3" x 6", quantity 1 (Bag of 10)
- J EZ-Tags Small  
2-1/4" x 5", quantity 1 (Bag of 10)
- K EZ-Dots 1 sheet of each:  
Veggie, Fruit, Protein, Grain & Milk
- L Food Safety Base Kit\*  
Various sizes, set of (8) signs

\*Second line does not include items: H or L

Create an *atmosphere* where *students want* to eat

PRIMARY cafés



Customize  text  color



B Banner set

C Various styles/sizes, p. 58-63



D 3 Frames | Choose (9) images, p. 54, 56

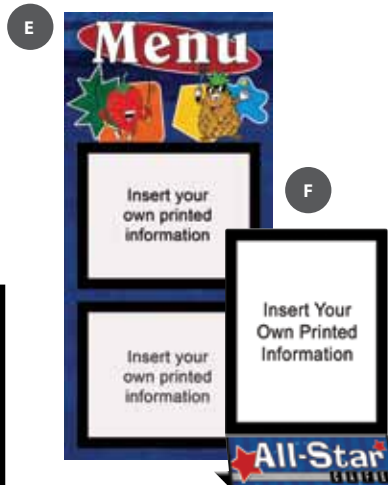

E

F



G

L

I/J/K

H

**\$3,900 Pack includes:** (DPP-Star)

Additional Line | **\$2,800** ea (DPPADD-Star)

- A Main Sign  
44" x 23", wall mount or ceiling hung
- B Banner Set (1) set consists of  
(2) 24" x 18" & (1) 48" x 18"
- C Wall Art  
Choose 3 individual pieces or 1 set
- D Change Art and Flip Frames  
22" x 28", choose (9) images
- E Menu Board 14" x 30"  
Coordinate with A
- F Counter Top Display  
10" x 15", coordinate with A
- G EAM Lunch & Breakfast  
24" x 20", quantity 1, (2) inserts
- H Healthy Link\*  
70" x 48", quantity 1, choose (6) images
- I EZ-Tags Large  
3" x 6", quantity 1 (Bag of 10)
- J EZ-Tags Small  
2-1/4" x 5", quantity 1 (Bag of 10)
- K EZ-Dots 1 sheet of each:  
Veggie, Fruit, Protein, Grain & Milk
- L Food Safety Base Kit\*  
Various sizes, set of (8) signs

\*Second line does not include items: H or L

Pays for itself with increased participation